

3-Way Thermostatic Mixing Valve

Size: 1/2"

Material: Brass

Key Features:

1. 3-Way Configuration: Designed with three ports to control the flow of three different water streams, typically mixing hot and cold water with a third input like a temperature-controlled supply.

2. Thermostatic Control: Maintains a consistent and safe water temperature by blending hot and cold water streams. The valve utilizes a temperature-sensitive element (e.g., a wax capsule) to react to temperature changes, adjusting the internal mechanism for precise temperature control.

3. Large Flow Proportional Master Mixing Valve: Capable of handling significant water flow while maintaining accurate temperature control.

4. Accurate Temperature Control: Ensures precise control over hot and cold water inlets to keep the mixed water within a safe temperature range, preventing scalding or discomfort.

In summary, the 3-Way Thermostatic Mixing Valve is specialized for maintaining consistent water temperatures by blending hot and cold water with a third input. Its accurate temperature control, large flow capacity, and durable construction make it suitable for various applications, including showers, sinks, and other water outlets in environments where safety and comfort are paramount, such as healthcare facilities, schools, hotels, and residential buildings.

DIMENSIONS	VALUE
A	130
B	88
C	-
D	1/2
E	33
F	103
G	74

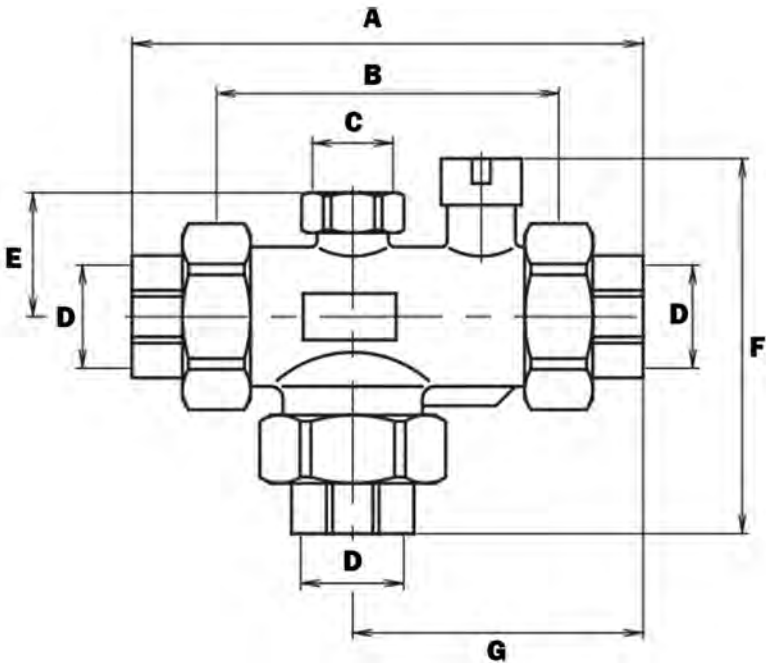

3-Way Thermostatic Mixing Valve

Size: 3/4"

Material: Brass

Key Features:

1. 3-Way Configuration: Designed with three ports to control the flow of three different water streams, typically mixing hot and cold water with a third input like a temperature-controlled supply.

2. Thermostatic Control: Maintains a consistent and safe water temperature by blending hot and cold water streams. The valve utilizes a temperature-sensitive element (e.g., a wax capsule) to react to temperature changes, adjusting the internal mechanism for precise temperature control.

3. Large Flow Proportional Master Mixing Valve: Capable of handling significant water flow while maintaining accurate temperature control.

4. Accurate Temperature Control: Ensures precise control over hot and cold water inlets to keep the mixed water within a safe temperature range, preventing scalding or discomfort.

In summary, the 3-Way Thermostatic Mixing Valve is specialized for maintaining consistent water temperatures by blending hot and cold water with a third input. Its accurate temperature control, large flow capacity, and durable construction make it suitable for various applications, including showers, sinks, and other water outlets in environments where safety and comfort are paramount, such as healthcare facilities, schools, hotels, and residential buildings.

DIMENSIONS	VALUE
A	141
B	99
C	G1/2
D	3/4
E	37
F	110
G	82

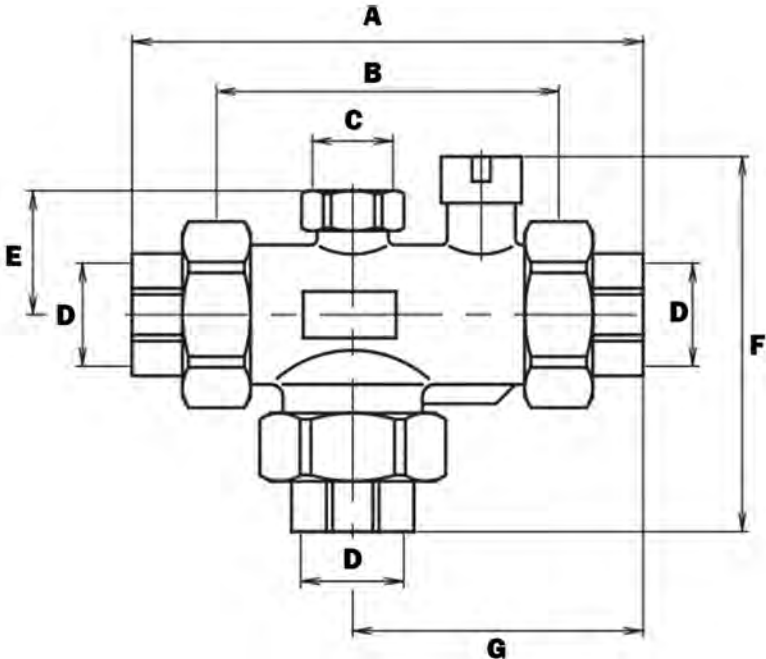

3-Way Thermostatic Mixing Valve

Size: 1"

Material: Brass

Key Features:

1. 3-Way Configuration: Designed with three ports to control the flow of three different water streams, typically mixing hot and cold water with a third input like a temperature-controlled supply.

2. Thermostatic Control: Maintains a consistent and safe water temperature by blending hot and cold water streams. The valve utilizes a temperature-sensitive element (e.g., a wax capsule) to react to temperature changes, adjusting the internal mechanism for precise temperature control.

3. Large Flow Proportional Master Mixing Valve: Capable of handling significant water flow while maintaining accurate temperature control.

4. Accurate Temperature Control: Ensures precise control over hot and cold water inlets to keep the mixed water within a safe temperature range, preventing scalding or discomfort.

In summary, the 3-Way Thermostatic Mixing Valve is specialized for maintaining consistent water temperatures by blending hot and cold water with a third input. Its accurate temperature control, large flow capacity, and durable construction make it suitable for various applications, including showers, sinks, and other water outlets in environments where safety and comfort are paramount, such as healthcare facilities, schools, hotels, and residential buildings.

DIMENSIONS	VALUE
A	160
B	110
C	G3/4
D	1
E	41
F	118
G	92

